

ELENCO PARTI / PARTS LIST

#	QTÀ / QTY	DESCRIZIONE / DESCRIPTION	CODICE / CODE
1	1	DB killer / DB killer	50.DK.092.0
2	1	Silenziatore / Muffler	OVAL
3	1	Protezione in gomma per staffa / Rubber protection for bracket	50.73.077.1
4	1	Staffa / Bracket	50.SS.030.0
5	1	Vite M8x50 / Screw M8x50	50.73.074.1
6	1	Rondella in alluminio / Aluminium washer	50.73.063.1
7	2	Boccola / Bush	50.73.381.1
8	1	Dado M8 flangiato / Flanged nut M8	50.73.393.1
9	1	Db Killer forato / Drilled DB killer	50.DK.082.0
10	1	Tubo di raccordo / Link pipe	9773H047S2
11	1	Guarnizione in grafite / Graphite bush	50.72.38.44.28
12	1	Fascetta Ø 44/47 mm / Pipe clamp Ø 44/47 mm	50.FA.006.1
13	1	Molla media / Middle spring	50.73.359.1
14	1	Tubo in gomma per molla / Rubber pipe for spring	50.73.049.0

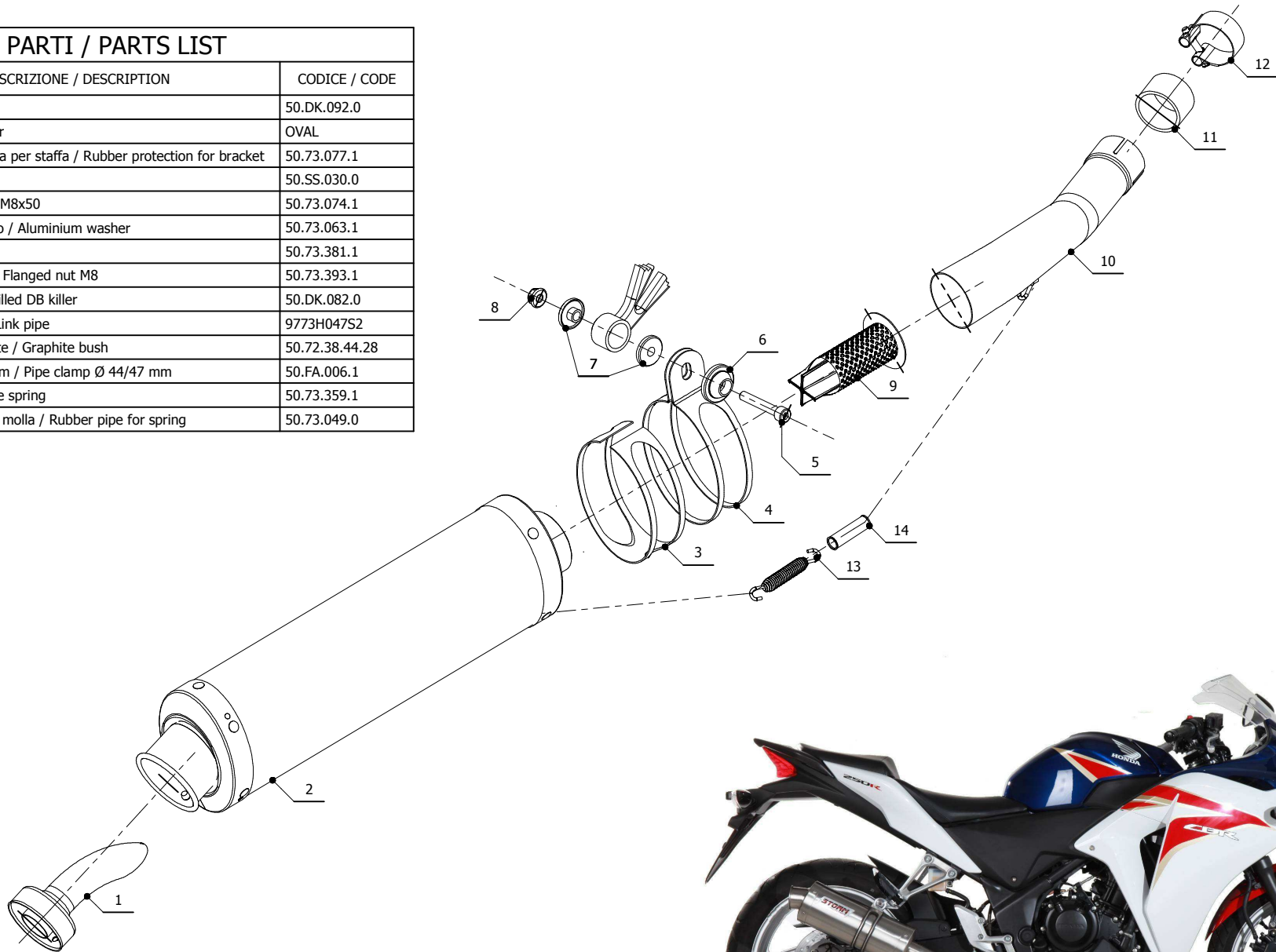

APPLICAZIONI / APPLICATIONS

CODICE / CODE	SILENZIATORE / MUFFLER	TUBO / PIPE	FASCETTA / CLAMP
74.H.047.LX1	INOX / ST. STEEL	INOX / ST. STEEL	INOX / ST. STEEL