

ELENCO PARTI / PARTS LIST

#	QTÀ / QTY	DESCRIZIONE / DESCRIPTION	CODICE / CODE
1	1	DB killer / DB killer	50.DK.021.0
2	1	Silenziatore / Muffler	OVAL
3	1	Protezione in gomma / Rubber protection	50.73.077.1
4	1	Staffa / Bracket	50.SS.030.0
5	1	Vite M8x25 / Screw M8x25	50.73.064.1
6	1	Rondella in alluminio / Aluminium washer	50.73.063.1
7	1	Staffa / Bracket	50.SS.892.0
8	1	Vite M8x40 / Screw M8x40	50.73.075.1
9	1	Rondella in alluminio / Aluminium washer	50.73.248.1
10	1	Rondella in alluminio / Aluminium washer	50.73.251.1
11	6	Dado M8 flangiato / Flanged nut M8	50.73.393.1
12	1	Tubo di raccordo 2-1 / Link pipe 2-1	9773K041S7C
13	1	Tubo di raccordo / Link pipe	9773K041S7A
14	1	Tubo di raccordo / Link pipe	9773K041S7B
15	2	Flangia / Flange	50.73.368.1
16	2	Boccola / Bush	50.73.367.1
17	7	Tubo in gomma per molla / Rubber pipe for spring	50.73.049.0
18	6	Molla media / Middle spring	50.73.359.1
19	1	Molla lunga / Long spring	50.71.080.1

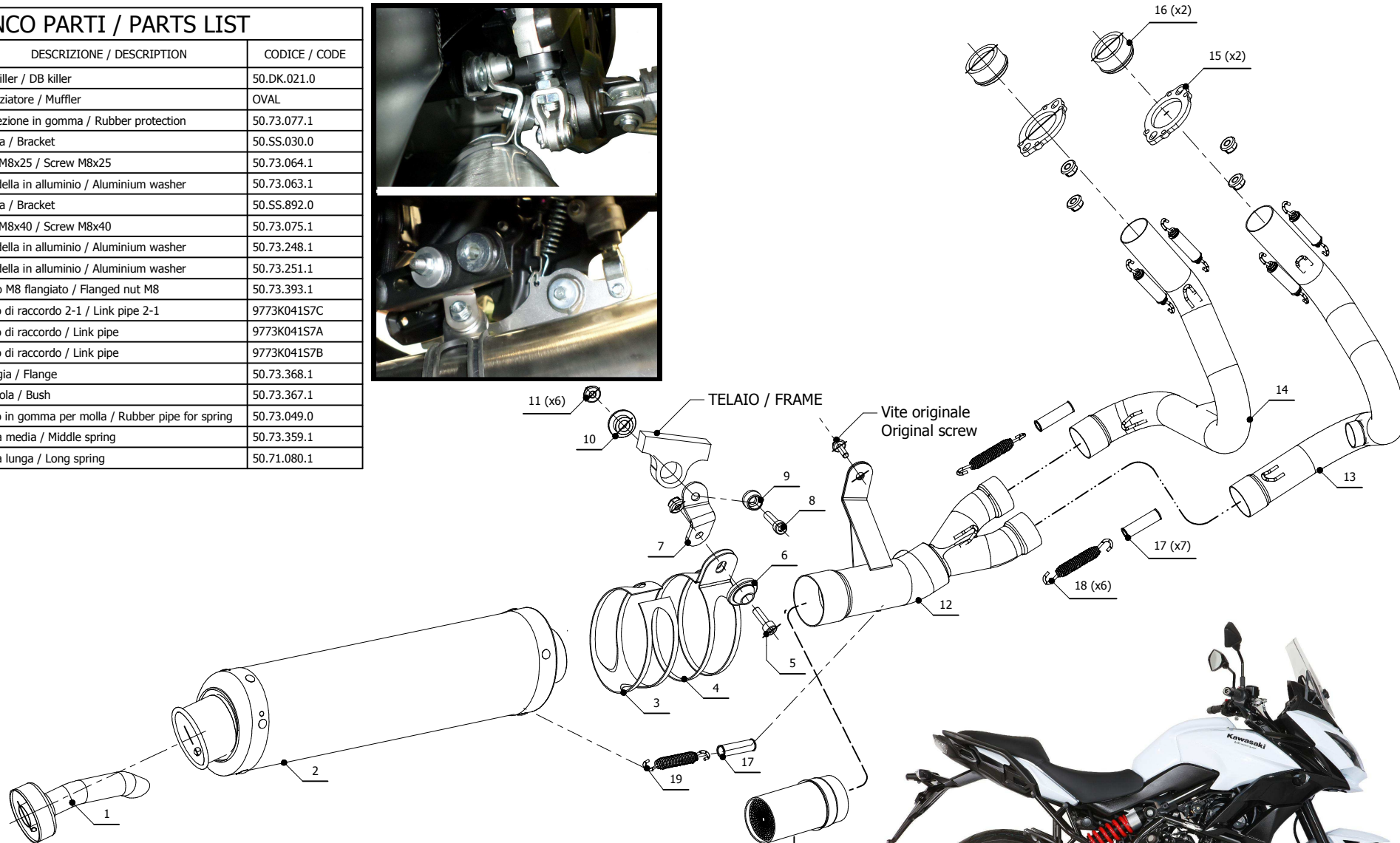
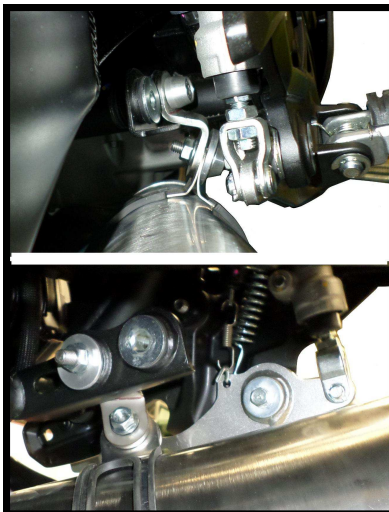

APPLICAZIONI / APPLICATIONS

CODICE / CODE	TUBO / PIPE	SILENZIATORE / MUFFLER	FASCETTA / CLAMP	NOTE
74.K.041.LX1	INOX / ST.STEEL	INOX / ST.STEEL	INOX / ST.STEEL	CATALYTIC CONVERTER NOT INCLUDED
74.K.041.KX1	INOX / ST.STEEL	INOX / ST.STEEL	INOX / ST.STEEL	CATALYTIC CONVERTER INCLUDED

Catalytic Converter
Cod. ACC.041.A1
Optional for K.041.LX1
Included in K.041.KX1

